

TECHNICAL MANUAL

**GENERAL SUPPORT MAINTENANCE
REPAIR PARTS AND SPECIAL TOOLS LIST
FOR
TEST SET, CRYSTAL MODULE TS-3630/GRA-114
(NSN 5895-01-057-6265)**

HEADQUARTERS, DEPARTMENT OF THE ARMY

9 DECEMBER 1983

TECHNICAL MANUAL
 TECHNICAL MANUAL
 No. 11-5895-1097-40P

HEADQUARTERS
 DEPARTMENT OF THE ARMY
 WASHINGTON, DC 9 DEC 1983

**GENERAL SUPPORT MAINTENANCE
 REPAIR PARTS AND SPECIAL TOOLS LIST
 FOR
 TEST SET, CRYSTAL, MODULE TS-3630/GRA-1 14
 (NSN 5895-01-057-6265)
 Current as of 17 October 1983**

REPORTING ERRORS AND RECOMMENDING IMPROVEMENTS

You can help improve this manual. If you find any mistakes or if you know of a way to improve the procedures, please let us know. Mail your letter, DA Form 2028 (Recommended Changes to Publications and Blank Forms), or DA Form 2028-2 located in back of this manual direct to: Commander, US Army Communications-Electronics Command and Fort Monmouth, ATTN: DRSEL: ME-MP, Fort Monmouth, NJ 07703.

In either case, a reply will be furnished direct to you.

Table of Contents

	Page	Illus Figure
SECTION I. Introduction	1	
II. Repair Parts List	5	
GROUP 00 Test Set, Crystal Module TS-3630/GRA-114	5	1
01 Case, Test Set	7	2
02 Panel Assembly	11	3
0201 Circuit Card Assembly (A1)	17	4
0202 Circuit Card Assembly (A2)	21	5
SECTION III. Special Tools List (Not applicable)		
IV. National Stock Number and Part Number Index	22	

**SECTION I
INTRODUCTION**

1. Scope

This manual lists spares and repair parts; special tools; special test, measurement, and diagnostic equipment (TMDE), and other special support equipment required for performance of general support maintenance of the TS-3630/GRA-114. It authorizes the requisitioning and issue of spares and repair parts as indicated by the source and maintenance codes.

2. General

This Repair Parts and Special Tools List is divided into the following sections:

a. Section II. Repair Parts List. A list of spares and repair parts authorized for use in the performance of maintenance. The list also includes parts which must be removed for replacement of the authorized parts. Parts lists are composed of functional groups in numeric sequence, with the parts in each group listed in figure and item number sequence.

b. Section III. Special Tools List. Not applicable.

c. Section IV National Stock Number and Part Number Index. A list, in National item identification number (NIIN) sequence, of all National stock numbers (NSN) appearing in the listings, followed by a list, in alphameric sequence, of all part numbers appearing in the listings. National stock numbers and part numbers are cross-referenced to each illustration figure and item number appearance.

3. Explanation of Columns

a. Illustration. This column is divided as follows:

(1) Figure number. Indicates the figure number of the illustration on which the item is shown.

(2) Item number. The number used to identify item called out in the illustration.

b. Source, Maintenance, and Recoverability (SMR) Codes.

(1) *Source code.* Source codes indicate the manner of acquiring support items for maintenance, repair, or overhaul of end items. Source codes are entered in the first and second positions of the Uniform SMR Code format as follows:

<i>Code</i>	<i>Definition</i>
PA	Item procured and stocked for anticipated or known usage.
PC	Item procured and stocked and which otherwise would be coded PA except that is deteriorative in nature.

PG - Item procured and stocked to provide for sustained support for the life of the equipment. It is applied to an item peculiar to the equipment which, because of probable discontinuance or shutdown of production facilities, would prove uneconomical to reproduce at a later time.

XA - Item is not procured or stocked because the requirements for the item will result in the replacement of the next higher assembly.

XB - Item is not procured or stocked. If not available through salvage, requisition.

XD - A support item that is not stocked. When required, item will be procured through normal supply channels.

NOTE

Cannibalization or salvage may be used as a source of supply for any items source coded above except those coded XA and aircraft support items as restricted by AR 750-1.

(2) *Maintenance code.* Maintenance codes are assigned to indicate the levels of maintenance authorized to USE and REPAIR support items. The maintenance codes are entered in the third and fourth positions of the Uniform SMR Code format as follows:

(a) The maintenance code entered in the third position will indicate the lowest maintenance level authorized to remove, replace, and use the support item. The maintenance code entered in the third position will indicate one of the following levels of maintenance:

<i>Code</i>	<i>Application/Explanation</i>
O	Support item is removed, replaced, used at the organizational level.
H	Support item is removed, replaced, used at the general support level.

(b) The maintenance code entered in the fourth position indicates whether the item is to be repaired and identifies the lowest maintenance level with the capability to perform complete repair (i.e., all authorized maintenance functions). This position will contain one of the following maintenance codes:

<i>Code</i>	<i>Application/Explanation</i>
H	The lowest maintenance level capable of complete repair of the support item is the general support level.
Z	Nonreparable. No repair is authorized.

(3) *Recoverability code.* Recoverability codes.

are assigned to support items to indicate the disposition action on unserviceable items. The recoverability code is entered in the fifth position of the Uniform SMR Code format as follows:

Recoverability

- | <i>codes</i> | <i>Definition</i> |
|--|--|
| Z - Nonreparable item. | When unserviceable, condemn and dispose at the level indicated in position 3. |
| H - Reparable item. | When uneconomically reparable, condemn and dispose at the general support level. |
| <i>c. National Stock Number.</i> Indicates the National stock number assigned to the item and will be used for requisitioning purposes. | |
| <i>d. Federal Supply Code for Manufacturer (FSCM).</i> The FSCM is a 5-digit numeric code listed in SB 708-41/42 which is used to identify the manufacturer, distributor, or Government agency, etc. | |
| <i>e. Part Number.</i> Indicates the primary number used by the manufacturer (individual, company, firm, corporation, or Government activity), which controls the design and characteristics of the item by means of its engineering drawings, specifications, standards, and inspection requirements to identify an item or range of items. | |

NOTE

When a stock numbered item is requisitioned, the repair part received may have a different part number than the part being replaced.

- f. Description.* Indicates the Federal item name and, if required, a minimum description to identify the item.
- g. Unit of Measure (U/M).* Indicates the standard of the basic quantity of the listed item as used in performing the actual maintenance function. This measure is expressed by a two-character alphabetical abbreviation (e.g., ea, in, pr, etc). When the unit of measure differs from the unit of issue, the lowest unit of issue that will satisfy the required units of measure will be requisitioned.
- h. Quantity Incorporated in Unit.* Indicates the quantity of the item used in the breakout shown on the illustration figure, which is prepared for a functional group, subfunctional group, or an assembly.

4. Special Information

- a. The following publications pertain to the TS-3630/GRA-114 and its components:

TM 11-5895-1097-12, Test Set, Crystal Module TS-3630/GRA-114

TM 11-5895-1097-20P, Test Set, Crystal Module TS-3630/GRA-114 (To be published)

TM 11-5895-1097-40, Test Set, Crystal Module TS-3630/GRA-114 (To be published)

- b. National stock numbers (NSN's) that are missing from P source coded items have been applied for and will be added to this TM by future change/revision when they are entered in the Army Master Data File (AMDF). Until the NSN's are established and published, submit exception requisitions to: Commander, US Army Communications-Electronics Command and Fort Monmouth, ATTN: DRSEL-MM, Fort Monmouth, New Jersey 07703 for the part required to support your equipment.

5. How to Locate Repair Parts

- a. When National stock number or part is unknown.
 - (1) *First.* Using the table of contents, determine the functional group within which the item belongs. This is necessary since illustrations are prepared for functional groups and listings are divided into the same groups.
 - (2) *Second.* Find the illustration covering the functional group to which the item belongs.
 - (3) *Third.* Identify the item on the illustration and note the illustration figure and item number of the item.
 - (4) *Fourth.* Using the Repair Parts Listing, find the figure and item number noted on the illustration.
- b. When National stock number or part number is known.
 - (1) *First.* Using the Index of National Stock Numbers and Part Numbers, find the pertinent National stock number or part number. This index is in NIIN sequence followed by a list of part numbers in alphameric sequence, cross-referenced to the illustration figure number and item number.
 - (2) *Second.* After finding the figure and item number, locate the figure and item number in the repair parts list.

6. Abbreviations

Not applicable.

(Next printed page is 4)

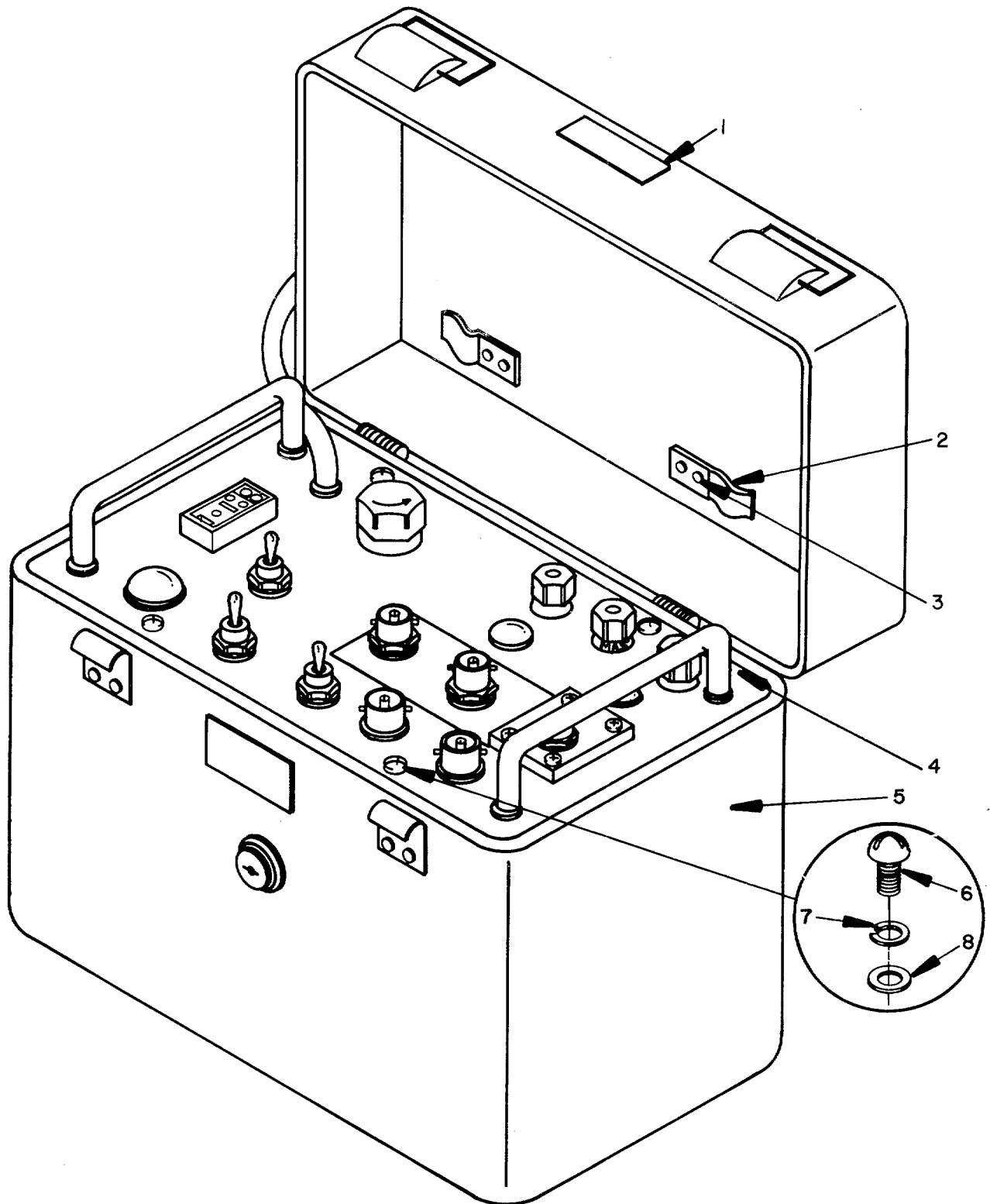

EL6RD001

Figure 1. Test Set, Crystal Module TS-3630/GRA-114.

SECTION II

TM 11-5895-1097-40P

(1) ILLUSTRATION		(2)	(3)	(4)	(5)	(6)	(7)	(8)
(a) FIG NO.	(b) ITEM NO.	SMR CODE	NATIONAL STOCK NUMBER	FSCM	PART NUMBER	DESCRIPTION USABLE ON CODE	U/M	QTY INC IN UNIT
						GROUP 00 TEST SET, CRYSTAL MODULE, TS-3630/GRA-114		
1	1	XBHZZ		80063	SM-C-865353	LABEL, IDENT	EA	1
1	2	XBHZZ		80063	SH-B-703916	CLIP, CABLE	EA	2
1	3	PAHZZ	5320-00-879-6606	96906	MS16535-154	RIVET, TUBULAR	EA	4
1	4	XBHHH		80063	S-D-703934	PANEL ASSY TEST SET	EA	1
1	5	XBHHH		19178	D14130	CASE, TEST SET	EA	1
1	6	PAHZZ		96906	MS5198-638	SCREW, MACHINE	EA	4
1	7	PAHZZ	5310-00-224-0749	96906	MS35338-1388	WASHER, LOCK	EA	4
1	8	PAHZZ	5310-00-194-3649	96906	MS15795-8088	WASHER, FLAT	EA	4

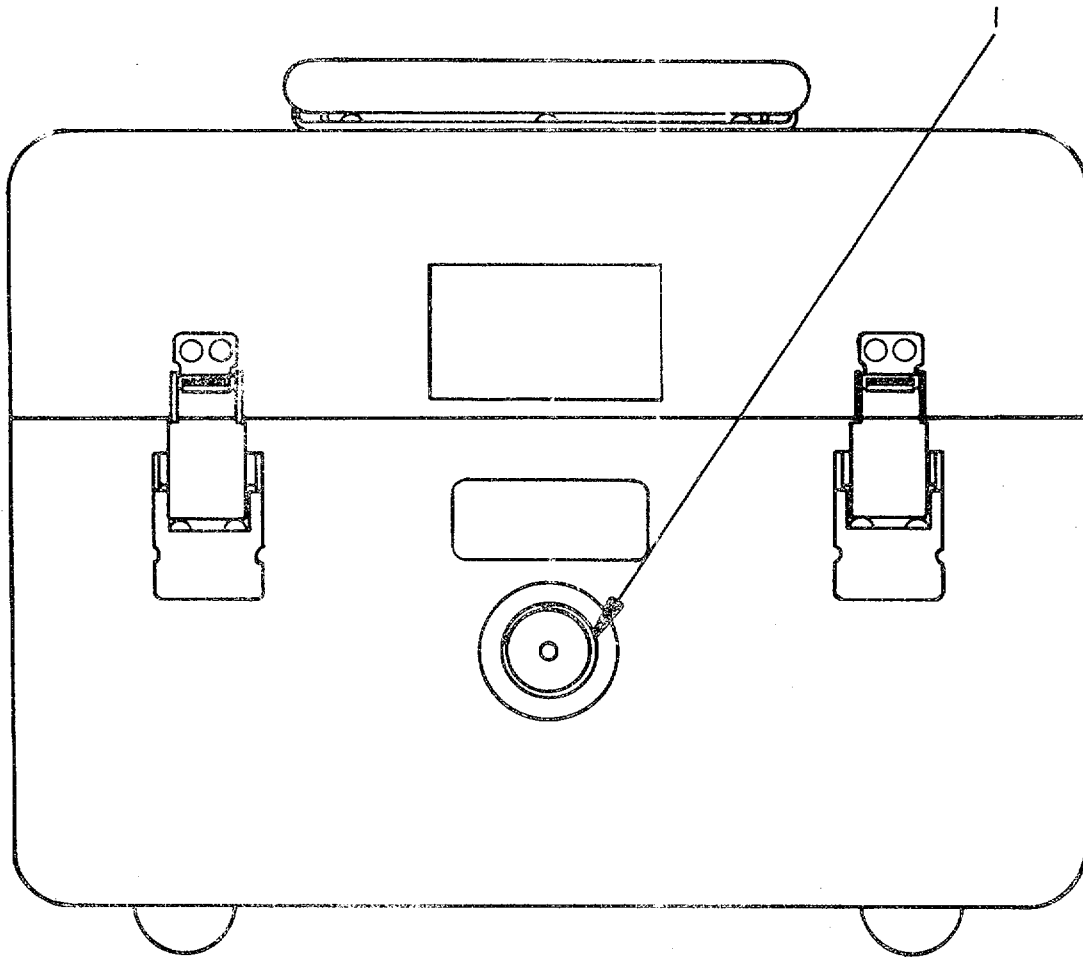

EL6RD002

Figure 2. Case, Test Set.

SECTION II

TM 11-5895-1097-40P

(1) ILLUSTRATION		(2)	(3)	(4)	(5)	(6)	(7)	(8)
(a) FIG NO.	(b) ITEM NO.	SMR CODE	NATIONAL STOCK NUMBER	FSCM	PART NUMBER	USABLE ON CODE	U/M	QTY INC IN UNIT
2	1	PAHZZ	4820-00-898-3003	98376	ZSP6-037-4	GROUP 01 CASE, TEST SET VALVE, VACUUM BREAKI.....	EA	1

7/(8 blank)

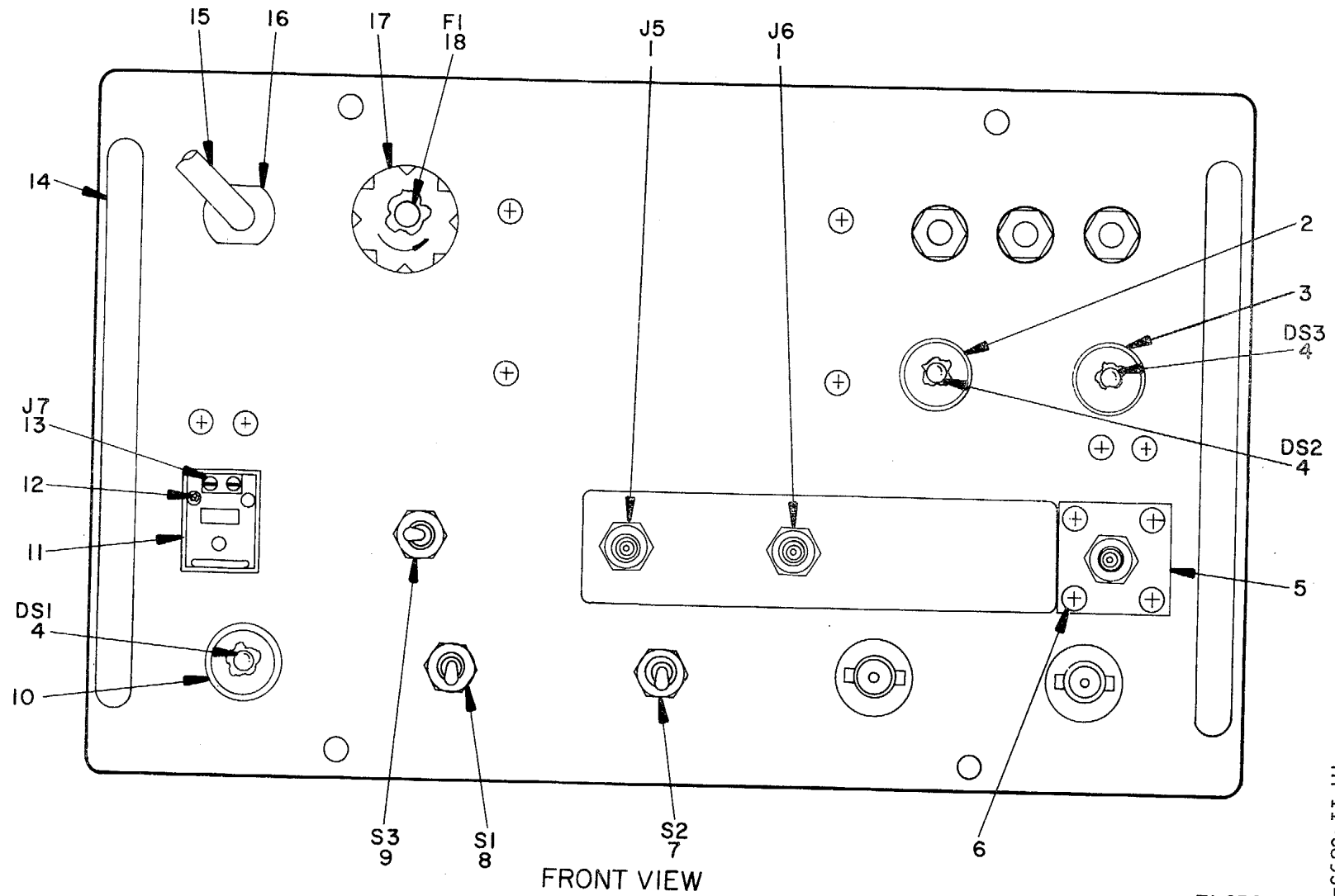
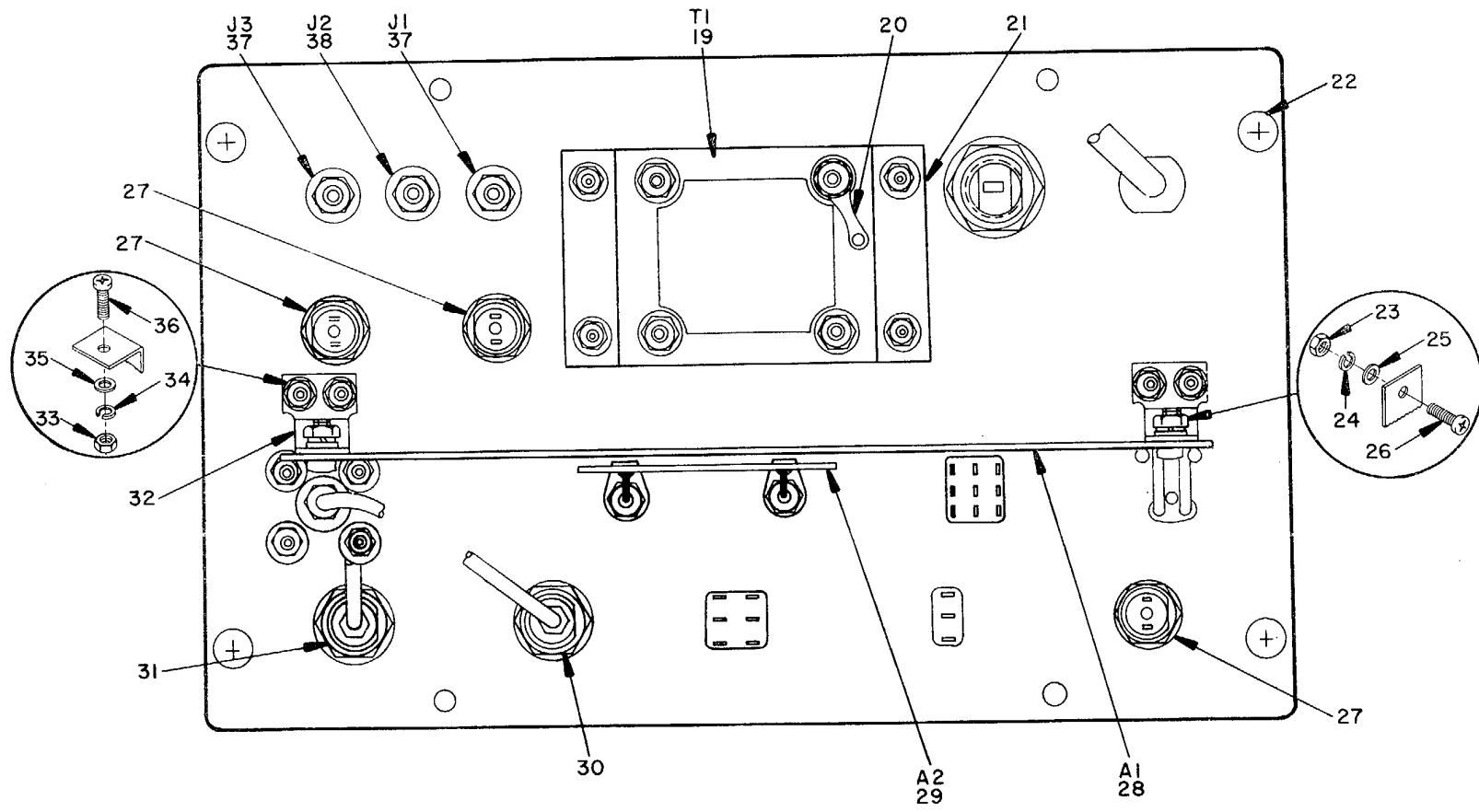

Figure 3. Panel Assembly (Sheet 1 of 2).



REAR VIEW

EL6RD004

Figure 3. Panel Assembly (Sheet 2 of 2).

(1) ILLUSTRATION		(2)	(3)	(4)	(5)	(6) DESCRIPTION	(7)	(8)
(a) FIG NO.	(b) ITEM NO.	SMR CODE	NATIONAL STOCK NUMBER	FSCM	PART NUMBER	USABLE ON CODE	U/M	QTY INC IN UNIT
GROUP 02 PANEL ASSEMBLY								
3	1	PAHZZ	5935-01-149-2994	19505	17-0204-000	CONNECTOR, PLUG, ELEC-.....	EA	2
3	2	PAOZZ	6210-00-176-4954	81349	LC35RT2	LENS, LIGHT.....	EA	1
3	3	PAOZZ	6210-00-176-4955	81349	LC35GT2	LENS, LIGHT.....	EA	1
3	4	PAOZZ	6240-00-965-1381	71744	CM-382	LAMP, INCANDESCENT.....	EA	3
3	5	XBHZZ		80063	SM-8-865346	PLATE, SPACER.....	EA	1
3	6	PAHZZ	5305-00-340-4748	96906	MS24693-68	SCREW, MACHINE.....	EA	4
3	7	PAHZZ	5930-00-106-5211	96906	MS75028-27	SWITCH, TOGGLE.....	EA	1
3	8	PAHZZ	5930-00-902-2395	96906	MS75028-23	SWITCH, TOGGLE.....	EA	1
3	9	PAHZZ	5930-00-918-5992	95146	MST-3050	SWITCH, TOGGLE.....	EA	1
3	10	PAOZZ	6210-00-183-0513	81349	LC35YT2	LENS, LIGHT.....	EA	1
3	11	XBHZZ		80063	SM-C-977773	HOLDER, CRYSTAL.....	EA	1
3	12	XDHZZ		96906	MS20470B2-4	RIVET, SOLID.....	EA	3
3	13	PAHZZ	5935-01-149-2472	91506	8004-4P4	CONNECTOR, RECEPTAC.....	EA	2
3	14	XBHZZ			10334-0032-SS-10	HANDLE, BOW.....	EA	2
				06540	32-6			
3	15	PAHZZ	6150-00-419-4305	16428	17236	CABLE ASSEMBLY, POWER.....	EA	1
3	16	PAHZZ	5975-00-351-6114	83330	939	BUSHING, STRAIN RELI.....	EA	1
3	17	PAHZZ	5920-00-952-9029	81349	FHN26W	FUSEHOLDER, EXTRACTO.....	EA	1
3	18	PAOZZ	5920-00-190-3348	81349	FHO3A250V1/4A	FUSE, CARTRIDGE.....	EA	1
3	19	PAHZZ	5950-00-078-7422	80223	H-935	TRANSFORMER, POWER.....	EA	1
3	20	PAHZZ	5940-00-513-3264	96906	MS77070-2	TERMINAL, LUG.....	EA	1
3	21	XBHZZ		80063	SMC-703909	BRACKET, XTMR.....	EA	1
3	22	PAHZZ	5305-01-141-4086	96906	MS24693C2708	SCREW, MACHINE.....	EA	4
3	23	PAHZZ	5310-00-689-3772	96906	MS35649-264B	NUT, PLAIN, HEXAGON.....	EA	6
3	24	PAHZZ	5310-00-224-0747	96906	MS35338-L368	WASHER, LOCK.....	EA	6
3	25	PAHZZ	5310-00-194-3648	96906	MS15795-8068	WASHER, FLAT.....	EA	6
3	26	PAHZZ	5305-00-448-6500	96906	MS51957-288	SCREW, MACHINE.....	EA	2
3	27	PAHZZ	6210-00-176-4928	81349	LH89/1	LIGHT, INDICATOR.....	EA	3
3	28	PAHHH	5895-01-096-8787	80063	SM-D-703940	CIRCUIT CARD ASSEMB.....	EA	1
3	29	PAHHH		80063	SM-D-984540	CIRCUIT CARD ASSY.....	EA	1
3	30	PAHZZ		80063	SM-C-977755	CABLE ASSEMBLY, SPEC.....	EA	1
3	31	PAHZZ		80063	SM-C-865333	CABLE ASSEMBLY, SPEC.....	EA	1
3	32	XBHZZ		80063	SN-8-703917	BRACKET, CKT CARD.....	EA	2
3	33	PAHZZ	5310-00-158-5259	96906	MS535649-2448	NUT, PLAIN, HEXAGON.....	EA	12
3	34	PAHZZ	5310-00-224-0746	96906	MS35338-1358	WASHER, LOCK.....	EA	12
3	35	PAHZZ	5310-00-687-6664	96906	MS15795-8048	WASHER, FLAT.....	EA	12
3	36	PAHZZ	5305-00-094-3430	96906	MS24693-48	SCREW, MACHINE.....	EA	8
3	37	PAHZZ	5940-00-842-6483	81349	PB01FA01	POST, BINDING, ELECTR.....	EA	2
3	38	PAHZZ	5940-00-044-1583	81349	PB01FA02	POST, BINDING, ELECTR.....	EA	1

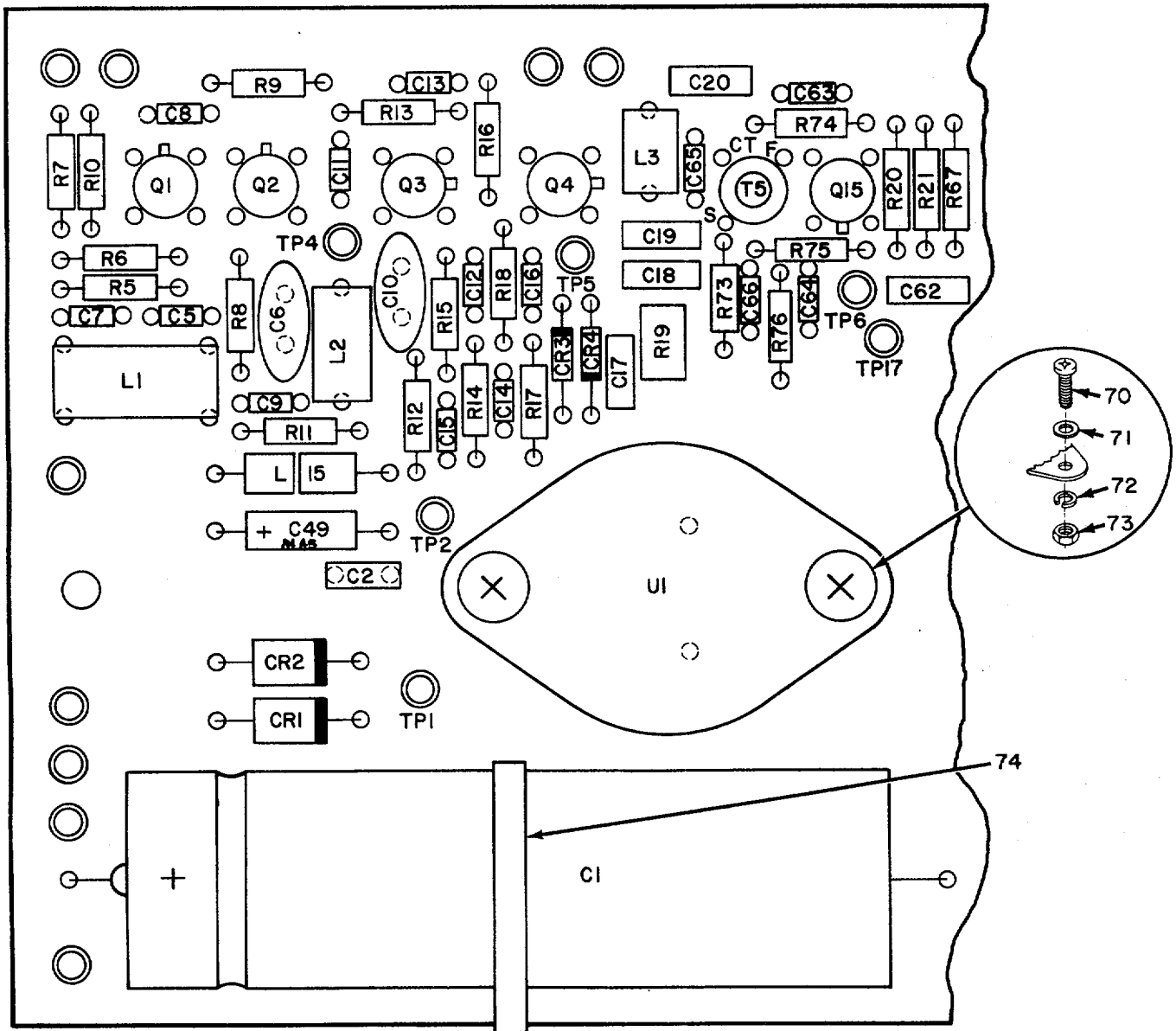

NOTE: FOR COMPLETE REFERENCE DESIGNATION, PREFIX WITH A1.

EL6R005

LEFT SIDE VIEW

Figure 4. Circuit Card Assembly (A1) (Sheet 1 of 5).

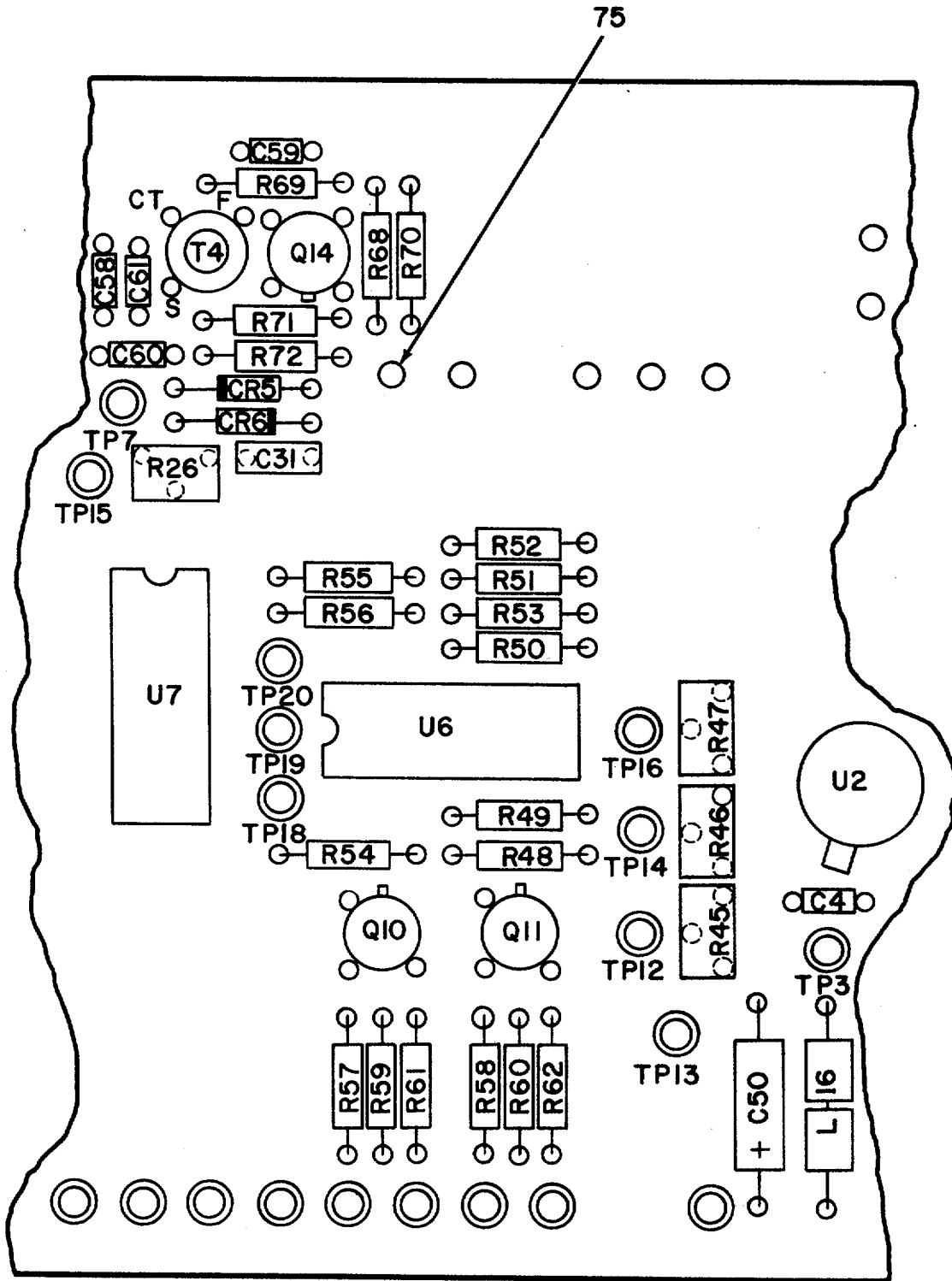

NOTE: FOR COMPLETE REFERENCE DESIGNATION, PREFIX WITH A1.

EL6RD006

CENTER VIEW

Figure 4. Circuit Card Assembly (A1) (Sheet 2 of 5).

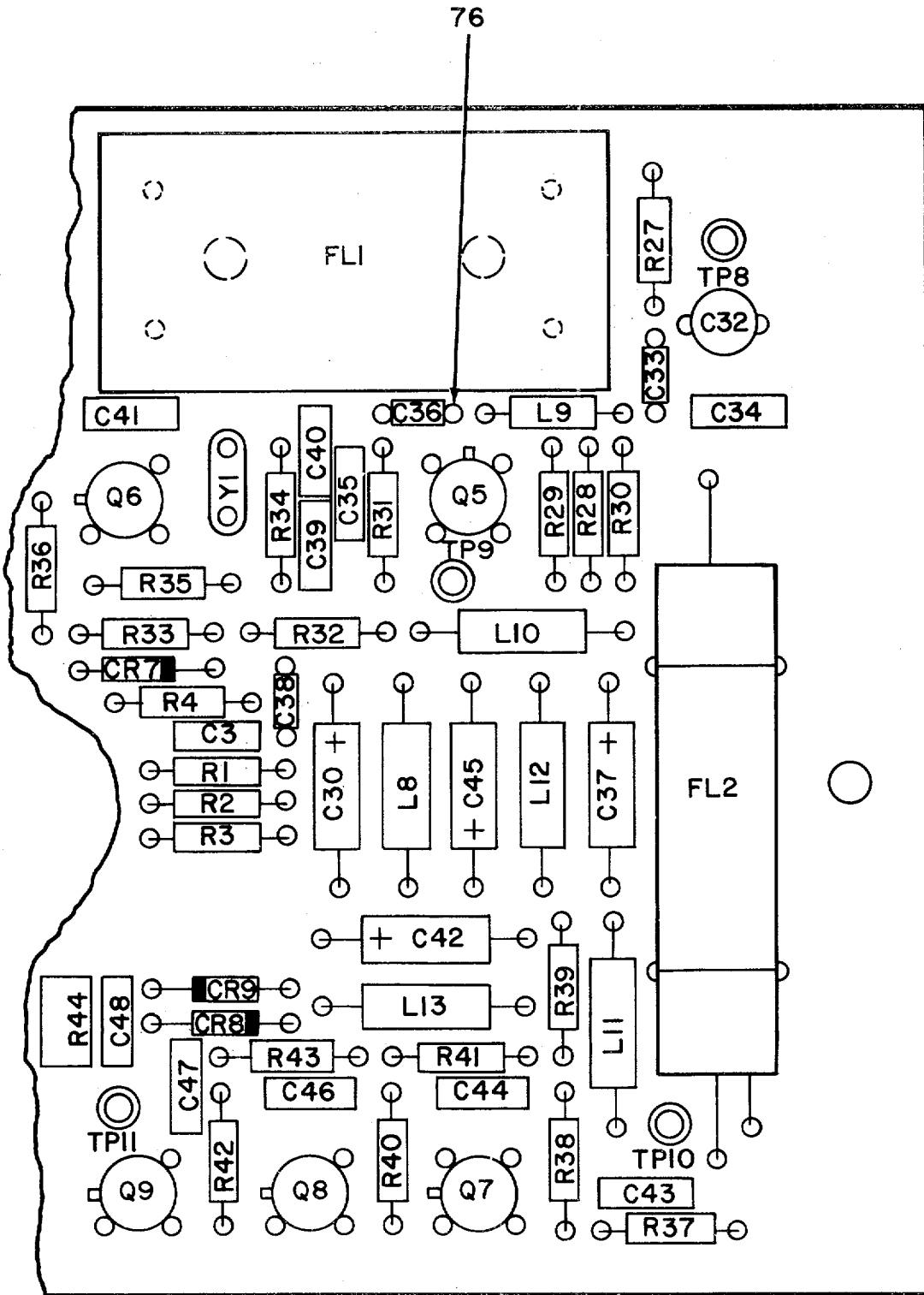

NOTE: FOR COMPLETE REFERENCE
DESIGNATION, PREFIX WITH A1.

EL6RD007

RIGHT SIDE VIEW

Figure 4. Circuit Card Assembly (A1) (Sheet 3 of 5).

REF. DES.	ITEM NO.	REF. DES.	ITEM NO.	REF. DES.	ITEM NO.	REF. DES.	ITEM NO.	REF. DES.	ITEM NO.
C1	1	C30	12	C50	12	FL2	24	Q9	32
C2	2	C31	2	C58	2	L1	25	Q10	32
C3	2	C32	13	C59	2	L2	26	Q11	32
C4	3	C33	14	C60	14	L3	27	Q14	33
C5	4	C34	15	C61	3	L8	28	Q15	33
C6	5	C35	16	C62	10	L9	29	R1	34
C7	4	C36	14	C63	2	L10	28	R2	35
C8	4	C37	12	C64	14	L11	28	R3	36
C9	4	C38	14	C65	3	L12	28	R4	37
C10	6	C39	17	C66	2	L13	28	R5	38
C11	7	C40	18	CR1	20	L15	30	R6	39
C12	3	C41	11	CR2	20	L16	30	R7	40
C13	8	C42	12	CR3	21	Q1	31	R8	41
C14	3	C43	19	CR4	21	Q2	31	R9	42
C15	3	C44	19	CR5	21	Q3	31	R10	43
C16	9	C45	12	CR6	21	Q4	31	R11	44
C17	2	C46	19	CR7	22	Q5	31	R12	45
C18	10	C47	14	CR8	21	Q6	32	R13	39
C19	11	C48	2	CR9	21	Q7	31	R14	46
C20	11	C49	12	FL1	23	Q8	32	R15	41

NOTE: FOR COMPLETE REFERENCE
DESIGNATION, PREFIX WITH A1.

EL6RD008

Figure 4. Circuit Card Assembly (A1) (Sheet 4 of 5).

REF. DES.	ITEM NO.	REF. DES.	ITEM NO.	REF. DES.	ITEM NO.	REF. DES.	ITEM NO.
R16	39	R40	56	R60	60	TP6	64
R17	46	R41	50	R61	51	TP7	64
R18	41	R42	57	R62	51	TP8	64
R19	47	R43	58	R67	61	TP9	64
R20	48	R44	47	R68	48	TP10	64
R21	49	R45	47	R69	43	TP11	64
R26	47	R46	47	R70	49	TP12	64
R27	50	R47	47	R71	62	TP13	64
R28	51	R48	43	R72	61	TP14	64
R29	52	R49	43	R73	61	TP15	64
R30	53	R50	43	R74	43	TP16	64
R31	43	R51	43	R75	62	TP17	64
R32	51	R52	43	R76	61	TP18	64
R33	50	R53	43	T4	63	TP19	64
R34	54	R54	50	T5	63	TP20	64
R35	50	R55	50	TP1	64	U1	65
R36	41	R56	50	TP2	64	U2	66
R37	55	R57	59	TP3	64	U6	67
R38	56	R58	59	TP4	64	U7	68
R39	50	R59	60	TP5	64	Y1	69

NOTE: FOR COMPLETE REFERENCE
DESIGNATION, PREFIX WITH A1.

EL6RDO09

Figure 4. Circuit Card Assembly (A1) (Sheet 5 of 5).

(1) ILLUSTRATION		(2)	(3)	(4)	(5)	(6)	(7)	(8)
(a) FIG NO.	(b) ITEM NO.	SMR CODE	NATIONAL STOCK NUMBER	FSCM	PART NUMBER	DESCRIPTION USABLE ON CODE	U/M	QTY INC IN UNIT
GROUP 0201 CIRCUIT CARD ASSEMBLY								
4	1	PCHZZ	5910-01-028-8226	81349	CE13C471G	CAPACITOR, FIXED, ELE.....	EA	1
4	2	PAHZZ	5910-00-600-6889	81349	139014/02-1230	CAPACITOR, FIXED, CER.....	EA	9
4	3	PAHZZ	5910-01-028-7835	81349	M39014-01-1237	CAPACITOR, FIXED, CER.....	EA	6
4	4	PAHZZ	5910-00-113-9448	81349	M39014/01-1354	CAPACITOR, FIXED, CER.....	EA	4
4	5	PAHZZ	5910-01-064-9674	81349	CMR04E200J0DR	CAPACITOR, FIXED, MIC.....	EA	1
4	6	PAHZZ	5910-01-053-5634	81349	CMR04C8R0D0DR	CAPACITOR, FIXED, MIC.....	EA	1
4	7	PAHZZ	5910-00-113-5445	81349	M39014/01-1339	CAPACITOR, FIXED, CER.....	EA	1
4	8	PAHZZ	59100-0-010-8534	81349	M39014-01-1347	CAPACITOR, FIXED, CER.....	EA	1
4	9	PAHZZ	5910-01-004-2465	81349	M39014/01-1332	CAPACITOR, FIXED, CER.....	EA	1
4	10	PAHZZ	5910-01-029-0728	81349	CMR03C100D0CR	CAPACITOR, FIXED, MIC.....	EA	2
4	11	PAHZZ	5910-01-038-7892	81349	CMR03E270G0CR	CAPACITOR, FIXED, MIC.....	EA	3
4	12	PAHZZ	5910-00-236-8740	81349	M39003-01-2974	CAPACITOR, FIXED, ELE.....	EA	6
4	13	PAHZZ	5910-01-117-8260	91293	9372	CAPACITOR, VARIABLE.....	EA	1
4	14	PAHZZ	5910-00-124-0659	81349	M39014-01-1575	CAPACITOR, FIXED, CER.....	EA	6
4	15	PAHZZ	5910-01-038-7909	81349	CMR03C3R0D0CR	CAPACITOR, FIXED, MIC.....	EA	1
4	16	PAHZZ	5910-01-031-9856	81349	CNR03C30G0CR	CAPACITOR, FIXED, MIC.....	EA	1
4	17	PAHZZ	5910-01-031-5372	81349	CMR03C8R0D0CR	CAPACITOR, FIXED, MIC.....	EA	1
4	18	PAHZZ		81349	CMR03E820G0CR	CAPACITOR, FIXED, MIC.....	EA	1
4	19	PAHZZ		81349	CMR03F111G0CR	CAPACITOR, FIXED, MIC.....	EA	3
4	20	PAHZZ	5961-00-924-6981	81349	JAN1N4245	SEMICONDUCTOR DEVIC.....	EA	2
4	21	PAHZZ	5961-00-232-3279	81349	JAN1N5711	SEMICONDUCTOR DEVIC.....	EA	6
4	22	PAHZZ	5961-00-842-9864	81349	JAN1N914	SEMICONDUCTOR DEVIC.....	EA	1
4	23	PAHZZ	5915-01-156-8589	53342	2368	FILTER, BAND PASS.....	EA	1
4	24	PAHZZ	5915-01-147-9384	06961	TL-40D-55A-2	FILTER, BAND PASS.....	EA	1
4	25	PAHZZ		80063	SM-C-706831-3	COIL, VARIABLE.....	EA	1
4	26	PAHZZ		80063	SM-B-707067	COIL, RADIO FREQ.....	EA	1
4	27	PAHZZ		80063	SM-8-977804	COIL, RADIO FREQUENC.....	EA	1
4	28	XAHZZ		96906	MS90537-50	COIL, RADIO FREQUENC.....	EA	5
4	29	PAHZZ	5950-00-031-4557	96906	MS55084-12	COIL, RADIO FREQUENC.....	EA	1
4	30	XBHZZ		80063	SM-B-706830	BEAD, FERRITE TWO (21 REQUIRED FOR L15 AND..... TWO (2) FOR L16	EA	4
4	31	PAHZZ	5961-00-905-4815	81349	JAN2N918	TRANSISTOR.....	EA	6
4	32	PAHZZ	5961-00-996-1894	81349	JANTX2N2222	TRANSISTOR.....	EA	5
4	33	PAHZZ	5961-00-926-7294	81349	JAN2N2857	TRANSISTOR.....	EA	2
4	34	PAHZZ		81349	RCR07C362JS	RESISTOR, FIXED, COMP.....	EA	1
4	35	PAHZZ		81349	RCD7C223GM	RESISTOR, FIXED, COMP.....	EA	1
4	36	PAHZZ		81349	RCR07G261JS	RESISTOR, FIXED, COMP.....	EA	1
4	37	PAHZZ	5905-00-246-9393	81349	RLR07G4R7JS	RESISTOR, FIXED, COMP.....	EA	1
4	38	PAHZZ	5905-00-141-0744	81349	RCR07G562JS	RESISTOR, FIXED, COMP.....	EA	1
4	39	PAHZZ	5905-00-110-7622	81349	RCR07G682JS	RESISTOR, FIXED, COMP.....	EA	3

(1) ILLUSTRATION		(2)	(3)	(4)	(5)	(6)	(7)	(8)
(a) FIG NO.	(b) ITEM NO.	SMR CODE	NATIONAL STOCK NUMBER	FSCM	PART NUMBER	DESCRIPTION USABLE ON CODE	U/M	QTY INC IN UNIT
4	40	PAHZZ	5905-00-126-6696	81349	RCR07G751JS	RESISTOR, FIXED, COMP	EA	1
4	41	PAHZZ	5905-00-135-3973	81349	RCR07G221JS	RESISTOR, FIXED, COMP	EA	4
4	42	PAHZZ	5905-00-133-0440	81349	RCR07G560JS	RESISTOR, FIXED, COMP	EA	1
4	43	PAHZZ	5905-00-126-6683	81349	RCR07G332JS	RESISTOR, FIXED, COMP	EA	10
4	44	PAHZZ	5905-00-119-8768	81349	RCR07G821JS	RESISTOR, FIXED, COMP	EA	1
4	45	PAHZZ	5905-00-135-6045	81349	RCR07G330JS	RESISTOR, FIXED, COMP	EA	1
4	46	PAHZZ	5905-00-121-9932	81349	RCR07G391JS	RESISTOR, FIXED, COMP	EA	2
4	47	PAHZZ	5905-01-067-9850	81349	RJR26FN503P	RESISTOR, VARIABLE, N	EA	6
4	48	PAHZZ	5905-00-116-2394	81349	RCR07G511JS	RESISTOR, FIXED, COMP	EA	2
4	49	PAHZZ	5905-00-110-7620	81349	RCR07G102JS	RESISTOR, FIXED, COMP	EA	2
4	50	PAHZZ	5905-00-106-3666	81349	RCR07G103JS	RESISTOR, FIXED, COMP	EA	8
4	51	PAHZZ	5905-00-110-0388	81349	RCR07G104JS	RESISTOR, FIXED, COMP	EA	4
4	52	PAHZZ	5905-00-141-0717	81349	RCR07G473JS	RESISTOR, FIXED, COMP	EA	1
4	53	PAHZZ	5905-00-104-8362	81349	RCR07G132JS	RESISTOR, FIXED, COMP	EA	1
4	54	PAHZZ	5905-00-141-0743	81349	RCR07G392JS	RESISTOR, FIXED, COMP	EA	1
4	55	PAHZZ	5905-00-106-1248	81349	RCR07G162JS	RESISTOR, FIXED, COMP	EA	1
4	56	PAHZZ	5905-00-485-4545	81349	RCR07G334JS	RESISTOR, FIXED, COMP	EA	2
4	57	PAHZZ	5905-00-104-8360	81349	RCR07G623JS	RESISTOR, FIXED, COMP	EA	1
4	58	PAHZZ	5905-01-092-1534	81349	RCR07G681JP	RESISTOR, FIXED, COMP	EA	1
4	59	PAHZZ	5905-00-114-0711	81349	RCR07G472JS	RESISTOR, FIXED, COMP	EA	2
4	60	PAHZZ	5905-00-116-8555	81349	RCR07G153JS	RESISTOR, FIXED, COMP	EA	2
4	61	PAHZZ	5905-00-141-1183	81349	RCR07G101JS	RESISTOR, FIXED, COMP	EA	4
4	62	PAHZZ	5905-00-107-0656	81349	RCR07G100JS	RESISTOR, FIXED, COMP	EA	2
4	63	PAHZZ		80063	SM-D-984552	TRANSFORMER, TOROID	EA	2
4	64	PAHZZ	5940-00-082-5002	81349	SE16XC01	TERMINAL, STUD TEST POINTS TP1 THRU TP20 ANDE1 THRU E9, E14 THRU E22.....	EA	38
4	65	PAHZZ	5962-01-084-5554	81349	M38510/10707BYC	MICROCIRCUIT, LINEAR.....	EA	1
4	66	PAHZZ	5962-00-197-3361	81349	M38510/10201BIC	MICROCIRCUIT	EA	1
4	67	PGHZZ	5962-01-088-3862	81349	M38510/11201BCB	MICROCIRCUIT, LINEAR.....	EA	1
4	68	PGHZZ	5962-01-025-2594	81349	M38510/05202BCB	MICROCIRCUIT, DIGITA.....	EA	1
4	69	XDHZZ	5955-01-067-7402	81349	CR69A/U	CRYSTAL UNIT, QUARTZ	EA	1
4	70	PAHZZ	5305-00-054-5647	96906	MS551957-13	SCREW, MACHINE	EA	2
4	71	PAHZZ	5310-00-194-3647	96906	MS15795-803	WASHER, FLAT	EA	4
4	72	PAHZZ	5310-00-224-0746	96906	MS35338-135B	WASHER, LOCK	EA	4
4	73	PAHZZ		80205	NAS671C48	NUT, PLAIN, HEXAGON	EA	4
4	74	PAHZZ	5975-00-074-2072	96906	MS3367-1-9	STRAP, TIEDOWN, ELECT	EA	1
4	75	XAHZZ		80063	SM-8-707052-1	FUNNELET.....	EA	7
4	76	PAHZZ	5940-00-283-8470	80063	145	POST, BINDING, ELECTR	EA	84

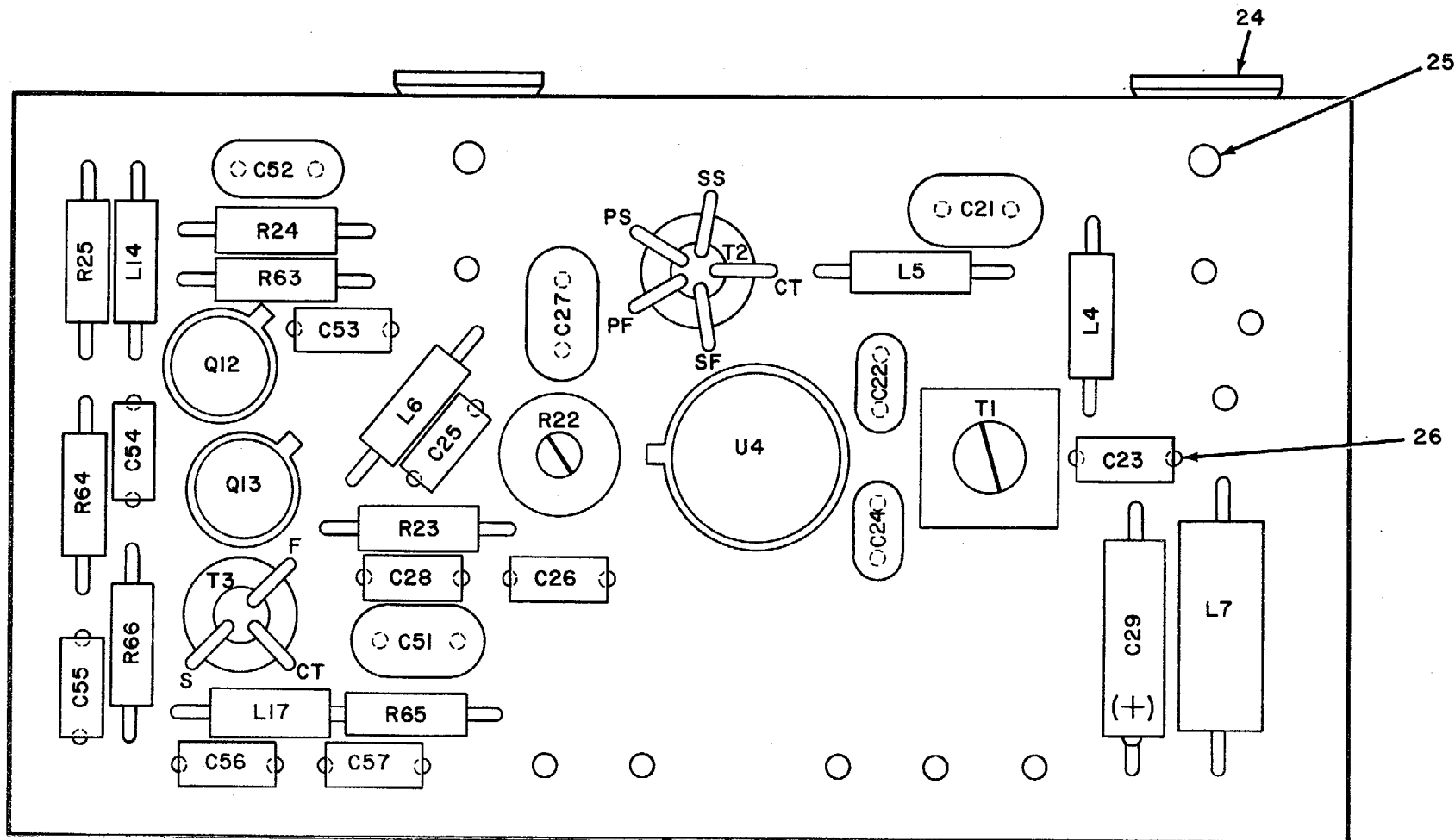

NOTE: FOR COMPLETE REFERENCE
DESIGNATION, PREFIX WITH A2.

EL6RDO10

MI
TT
-

Figure 5. Circuit Card Assembly (A2) (Sheet 1 of 2).

REF. DES.	ITEM NO.	REF. DES.	ITEM NO.	REF. DES.	ITEM NO.	REF. DES.	ITEM NO.
C21	1	C51	1	L6	7	R25	16
C22	2	C52	5	L7	9	R63	17
C23	3	C53	6	L14	10	R64	18
C24	2	C54	6	L17	11	R65	17
C25	3	C55	6	Q12	12	R66	19
C26	3	C56	6	Q13	12	T1	20
C27	1	C57	6	R22	13	T2	21
C28	3	L4	7	R23	14	T3	22
C29	4	L5	8	R24	15	U4	23

NOTE: FOR COMPLETE REFERENCE DESIGNATION, PREFIX WITH A2.

EL6RD011

Figure 5. Circuit Card Assembly (A2) (Sheet 2 of 2).

(1) ILLUSTRATION		(2)	(3)	(4)	(5)	(6)	(7)	(8)
(a) FIG NO.	(b) ITEM NO.	SMR CODE	NATIONAL STOCK NUMBER	FSCM	PART NUMBER	DESCRIPTION USABLE ON CODE	U/M	QTY INC IN UNIT
GROUP 0202 CIRCUIT CARD ASSEMBLY								
5	1	PAHZZ	5910-01-093-6320	81349	CMR03F271G0YR	CAPACITOR, FIXED, MIC	EA	3
5	2	PAHZZ			8121-100-S24-47	CAPACITOR, FIXED MIC	EA	2
				72982	PFJ			
5	3	PAHZZ	5910-00-124-0659	81349	M39014-01-1575	CAPACITOR, FIXED, CER	EA	4
5	4	PAHZZ	5910-00-236-8740	81349	M39003-01-2974	CAPACITOR, FIXED, ELE	EA	1
5	5	PAHZZ	5910-01-031-5372	81349	CMR03CBR0DOCF	CAPACITOR, FIXED, MIC	EA	1
5	6	PAHZZ	5910-00-010-8666	81349	39014/01-1357	CAPACITOR, FIXED, CER	EA	5
5	7	PAHZZ	5950-00-031-4561	96906	MS75084-4	COIL, RADIO FREQUENC	EA	2
5	8	PAHZZ	5950-00-035-4416	96906	MS75083-13	COIL, RADIO FREQUENC	EA	1
5	9	XAHZZ		96906	MS90537-50	COIL, RADIO FREQUENC	EA	1
5	10	PAHZZ	5950-00-035-4417	96906	MS75083-5	COIL, RADIO FREQUENC	EA	1
5	11	XBHZZ		80063	SM-8-706830	BEAD, FERRITE	EA	1
5	12	PAHZZ	5961-00-926-7294	81349	JAN2N2857	TRANSISTOR	EA	2
5	13	PAHZZ	5905-00-758-4033	81349	RJ5DCP501	RESISTOR, VARIABLE, N	EA	1
5	14	PAHZZ	5905-00-105-7768	81349	RCR07G561JS	RESISTOR, FIXED, COMP	EA	1
5	15	PAHZZ	5905-00-106-1356	81349	RCR07G152JS	RESISTOR, FIXED, COMP	EA	1
5	16	PAHZZ	5905-01-092-1535	81349	RCRO7G471JP	RESISTOR, FIXED, COMP	EA	1
5	17	PAHZZ	5905-00-141-1183	81349	RCR07GL01JS	RESISTOR, FIXED, COMP	EA	2
5	18	PAHZZ	5905-00-111-4727	81349	RCR07G272JS	RESISTOR, FIXED, COMP	EA	1
5	19	PAHZZ	5905-00-114-5343	81349	RCRO7G182JS	RESISTOR, FIXED, COMP	EA	1
5	20	PAHZZ	5950-01-147-6870	18486	E051282-R1	TRANSFORMER	EA	1
5	21	PAHZZ		80063	SN-C-984531	TRANSFORMER, TOROID	EA	1
5	22	PAHZZ		80063	SM-D-984552	TRANSFORMER, TOROID	EA	1
5	23	PAHZZ	5961-01-149-7046	80063	SM-D-707053	SEMICONDUCTOR DEVIC	EA	1
5	24	PAHZZ	5940-00-583-7741	96906	M577068-4	TERMINAL, LUG	EA	2
5	25	PAHZZ	5320-00-448-8241	96906	MS16535-101	RIVET, TUBULAR	EA	2
5	26	PAHZZ	5940-00-283-8470	80063	145	POST, BINDING, ELECTR	EA	30

SECTION IV

TM 11-5895-1097-40P

**CROSS- REFERENCE-INDEXES
NATIONAL STOCK NUMBER INDEX**

STOCK NUMBER	FIG.	ITEM	STOCK NUMBER	FIG.	ITEM
5910-00-010-8534	4	8	5910-00-236-8740	4	12
5910-00-010-8666	5	6	5910-00-236-8740	5	4
5950-00-031-4557	4	29	5905-00-246-9393	4	37
5950-00-031-4561	5	7	5940-00-283-8470	4	76
5950-00-035-4416	5	8	5940-00-283-8470	5	26
5950-00-035-4417	5	10	5305-00-340-4748	3	6
5940-00-044-1583	3	38	5975-00-351-6114	3	16
5305-00-054-5647	4	70	6150-00-419-4305	3	15
5975-00-074-2072	4	74	5305-00-448-6500	3	26
5950-00-078-7422	3	19	5320-00-448-8241	5	25
5940-00-082-5002	4	64	5905-00-485-4545	4	56
5305-00-094-3430	3	36	5940-00-513-3264	3	20
5905-00-104-8360	4	57	5940-00-583-7741	5	24
5905-00-104-8362	4	53	5910-00-600-6889	4	2
5905-00-105-7768	5	14	5310-00-687-6664	3	35
5905-00-106-1248	4	55	5310-00-689-3772	3	23
5905-00-106-1356	5	15	5905-00-758-4033	5	13
5905-00-106-3666	4	50	5940-00-842-6483	3	37
5930-00-106-5211	3	7	5961-00-842-9864	4	22
5905-00-107-0656	4	62	5320-00-879-6606	1	3
5905-00-110-0388	4	51	4820-00-898-3003	2	1
5905-00-110-7620	4	49	5930-00-902-2395	3	8
5905-00-110-7622	4	39	5961-00-905-4815	4	31
5905-00-111-4727	5	18	5930-00-918-5992	3	9
5910-00-113-5445	4	7	5961-00-924-6981	4	20
5910-00-113-9448	4	4	5961-00-926-7294	4	33
5905-00-114-0711	4	59	5961-00-926-7294	5	12
5905-00-114-5343	5	19	5920-00-952-9029	3	17
5905-00-116-2394	4	48	6240-00-965-1381	3	4
5905-00-116-8555	4	60	5961-00-996-1894	4	32
5905-00-119-8768	4	44	5910-01-004-2465	4	9
5905-00-121-9932	4	46	5962-01-025-2594	4	68
5910-00-124-0659	4	14	5910-01-028-7835	4	3
5910-00-124-0659	5	3	5910-01-028-8226	4	1
5905-00-126-6683	4	43	5910-01-029-0728	4	10
5905-00-126-6696	4	40	5910-01-031-5372	4	17
5905-00-133-0440	4	42	5910-01-031-5372	5	5
5905-00-135-3973	4	41	5910-01-031-9856	4	16
5905-00-135-6045	4	45	5910-01-038-7892	4	11
5905-00-141-0717	4	52	5910-01-038-7909	4	15
5905-00-141-0743	4	54	5910-01-053-5634	4	6
5905-00-141-0744	4	38	5910-01-064-9674	4	5
5905-00-141-1183	4	61	5955-01-067-7402	4	69
5905-00-141-1183	5	17	5905-01-067-9850	4	47
5310-00-158-5259	3	33	5962-01-084-5554	4	65
6210-00-176-4928	3	27	5962-01-088-3862	4	67
6210-00-176-4954	3	2	5905-01-092-1534	4	58
6210-00-176-4955	3	3	5905-01-092-1535	5	16
6210-00-183-0513	3	10	5910-01-093-6320	5	1
5920-00-190-3348	3	18	5895-01-096-8787	3	28
5310-00-194-3647	4	71	5910-01-117-8260	4	13
5310-00-194-3648	3	25	5305-01-141-4086	3	22
5310-00-194-3649	1	8	5950-01-147-6870	5	20
5962-00-197-3361	4	66	5915-01-147-9384	4	24
5310-00-224-0746	3	34	5935-01-149-2472	3	13
5310-00-224-0746	4	72	5935-01-149-2994	3	1
5310-00-224-0741	3	24	5961-01-149-7046	5	23
5310-00-224-0749	1	7	5915-01-156-8589	4	23
5961-00-232-3279	4	21			

FSCM	PART NUMBER	FIGURE NO.	ITEM NO.	FSCM	PART NUMBER	FIGURE NO.	ITEM NO.
81349	CE13C471G	4	1	81349	FHN26W	3	17
71744	CR-382	3	4	81349	FM03A250V1/4A	3	18
81349	CMR03C100D0CR	4	10	80223	H-935	3	19
81349	CMR03C3R0D0CR	4	15	81349	JANTX2N2222	4	32
81349	CMR03C8R0D0CR	4	17	81349	JAN1N4245	4	20
81349	CMR03C8R0D0CR	5	5	81349	JAN1N5711	4	21
81349	CMR03E270G0CR	4	11	81349	JAN1N914	4	22
81349	CMR03E430G0CR	4	16	81349	JAN2N2857	4	33
81349	CMR03E820G0CR	4	18	81349	JAN2N2857	5	12
81349	CMR03F111G0CR	4	19	81349	JAN2N918	4	31
81349	CMR03F271G0YR	5	1	81349	LC35GT2	3	3
81349	CMR04C8R0D0DR	4	6	81349	LC35RT2	3	2
81349	CMR04E200J0DR	4	5	81349	LC35YT2	3	10
81349	CR69A/U	4	69	81349	LH89/1	3	27
19178	014130	1	5	95146	MST-305D	3	9
18486	E051282-R1	5	20	96906	M515795-803B	4	71

NATIONAL STOCK NUMBER AND PART NUMBER INDEX

FSCM	PART NUMBER	FIGURE NO.	ITEM NO.	FSCM	PART NUMBER	FIGURE NO.	ITEM NO.
96906	MS15795-8048	3	35	81349	RCR07G182JS	5	19
96906	MS15795-8068	3	25	81349	RCR07G221JS	4	41
96906	MS15795-8088	1	8	81349	RCR07G261JS	4	36
96906	MS16535-101	5	25	81349	RCR07G272JS	5	18
96906	MS16535-154	1	3	81349	RCR07G330JS	4	45
96906	MS2047082-4	3	12	81349	RCR07G332JS	4	43
96906	MS24693-4B	3	36	81349	RCR07G334JS	4	56
96906	MS24693-68	3	6	81349	RCR07G391JS	4	46
96906	MS24693C270B	3	22	81349	RCR07G392JS	4	54
96906	MS3367-1-9	4	74	81349	RCR07G471JP	5	16
96906	MS35338-135B	3	34	81349	RCR07G472JS	4	59
96906	MS35338-135B	4	72	81349	RCR07G473JS	4	52
96906	MS35338-136B	3	24	81349	RCR07G511JS	4	48
96906	MS35338-138B	1	7	81349	RCR07G560JS	4	42
96906	MS35649-244B	3	33	81349	RCR07G561JS	5	14
96906	MS35649-264B	3	23	81349	RCR07G562JS	4	38
96906	MS51957-13	4	70	81349	RCR07G623JS	4	57
96906	MS51957-288	3	26	81349	RCR07G681JP	4	58
96906	MS5198-638	1	6	81349	RCR07G682JS	4	39
96906	MS75028-23	3	8	81349	RCR07G751JS	4	40
96906	MS75028-27	3	7	81349	RCR07G821JS	4	44
96906	MS75083-13	5	8	81349	RJR26FW503P	4	47
96906	MS75083-5	5	10	81349	RJ50CP501	5	13
96906	MS75084-12	4	29	81349	RLR07G4R7JS	4	37
96906	MS75084-4	5	7	81349	SE16XC01	4	64
96906	MS77068-4	5	24	80063	SM-B-703916	1	2
96906	MS77070-2	3	20	80063	SM-B-703917	3	32
96906	MS90537-50	4	28	80063	SM-B-706830	4	30
96906	MS90537-50	5	9	80063	SM-B-706830	5	11
81349	M38510/052028C8	4	68	80063	SM-B-707052-1	4	75
81349	M38510/10201B1C	4	66	80063	SM-B-707067	4	26
81349	M38510/107078YC	4	65	80063	SM-B-865346	3	5
81349	M38510/11201BCB	4	67	80063	SM-B-977804	4	27
81349	M39003-01-2974	4	12	80063	SM-C-703909	3	21
81349	M39003-01-2974	5	4	80063	SM-C-706831-3	4	25
81349	M39014-01-1237	4	3	80063	SM-C-865333	3	31
81349	M39014-01-1347	4	8	80063	SM-C-865353	1	1
81349	M39014-01-1575	4	14	80063	SM-C-977755	3	30
81349	M39014-01-1575	5	3	80063	SM-C-977773	3	11
81349	M39014/01-1332	4	9	80063	SM-C-984531	5	21
81349	M39014/01-1339	4	7	80063	SM-D-703934	1	4
81349	M39014/01-1354	4	4	80063	SM-D-703940	3	28
81349	M39014/01-1357	5	6	80063	SM-D-707053	5	23
81349	M39014/02-1230	4	2	80063	SM-D-984540	3	29
80205	NAS671C48	4	73	80063	SM-D-984552	4	63
81349	PB01FA01	3	37	80063	SM-D-984552	5	22
81349	PB01FA02	3	38	06961	TL-40D-55A-2	4	24
81349	RCR07C223GM	4	35	98376	ZSP6-037-4	2	1
81349	RCR07C362JS	4	34	06540	10334-0032-SS-1032-6	3	14
81349	RCR07G100JS	4	62	80063	145	4	76
81349	RCR07G101JS	4	61	80063	145	5	26
81349	RCR07G101JS	5	17	19505	17-0204-000	3	1
81349	RCR07G102JS	4	49	16428	17236	3	15
81349	RCR07G103JS	4	50	53342	2368	4	23
81349	RCR07G104JS	4	51	91506	8004-4P4	3	13
81349	RCR07G132JS	4	53	72982	812L-100-S24-47PFJ	5	2
81349	RCR07G152JS	5	15	91293	9372	4	13
81349	RCR07G153JS	4	60	83330	939	3	16
81349	RCR07G162JS	4	55				

By Order of the Secretary- of the Army:

JOHN A. WICKHAM JR.
General, United States Army
Chief of Staff

Official:

ROBERT M. JOYCE
Major General, United States Army
The Adjutant General

Distribution:

To be distributed in accordance with special list.

RECOMMENDED CHANGES TO EQUIPMENT TECHNICAL PUBLICATIONS



THEN... JOT DOWN THE DOPE ABOUT IT ON THIS FORM, CAREFULLY TEAR IT OUT, FOLD IT AND DROP IT IN THE MAIL!

SOMETHING WRONG WITH THIS PUBLICATION?

FROM: (PRINT YOUR UNIT'S COMPLETE ADDRESS)

DATE SENT

PUBLICATION NUMBER

PUBLICATION DATE

PUBLICATION TITLE

BE EXACT... PIN-POINT WHERE IT IS

PAGE NO.	PARA-GRAPH	FIGURE NO.	TABLE NO.
----------	------------	------------	-----------

IN THIS SPACE TELL WHAT IS WRONG AND WHAT SHOULD BE DONE ABOUT IT:

TEAR ALONG PERFORATED LINE

PRINTED NAME, GRADE OR TITLE, AND TELEPHONE NUMBER

SIGN HERE:

DA FORM 2028-2
1 JUL 79

PREVIOUS EDITIONS ARE OBSOLETE.

P.S.—IF YOUR OUTFIT WANTS TO KNOW ABOUT YOUR RECOMMENDATION MAKE A CARBON COPY OF THIS AND GIVE IT TO YOUR HEADQUARTERS.

PIN: 054504-000